

T10PX Software Update Method

Whenever improvements and new functions are available, the software of your T10PX radio transmitter can be updated easily via online free of charge. The updated software file will be shown on our website. You can download it and make a copy on your microSD card. Below is the procedure for the software update.

Required for update (Purchase separately)

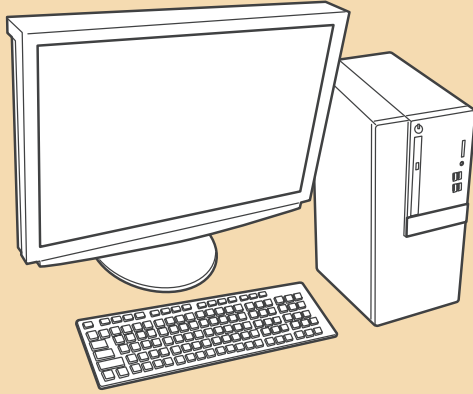

PC
(Access is possible by the web)



microSD card

Note: Before you update the software, the battery that is connected to the T10PX should be fully charged.

Note: During the software update, the model data that is stored in the T10PX should be kept without any change. (NOT erased and NOT changed.) However, for your safety, making a backup of your model data before the software update is highly recommended.

Updating procedure

1. Download the zip file of the update data from our website or your local distributor's website.

<https://futabausa.com/>

2. Extract the zip file on your computer.

3. Insert the micro SD card into the PC and copy the FUTABA folder expanded on the PC to the micro SD card.

If you already have a microSD card FUTABA folder, overwrite it.

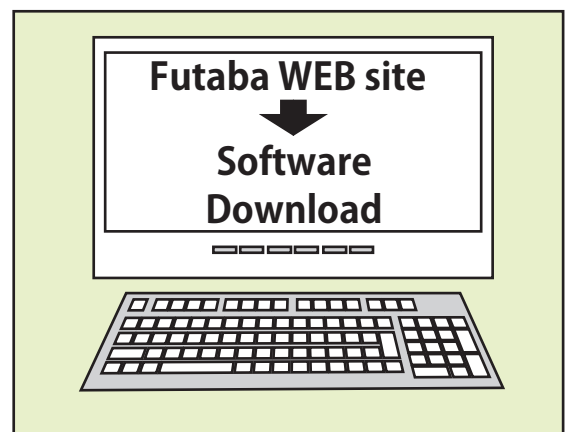

FUTABA



4. Insert the micro SD card with the copied FUTABA folder into the T10PX.

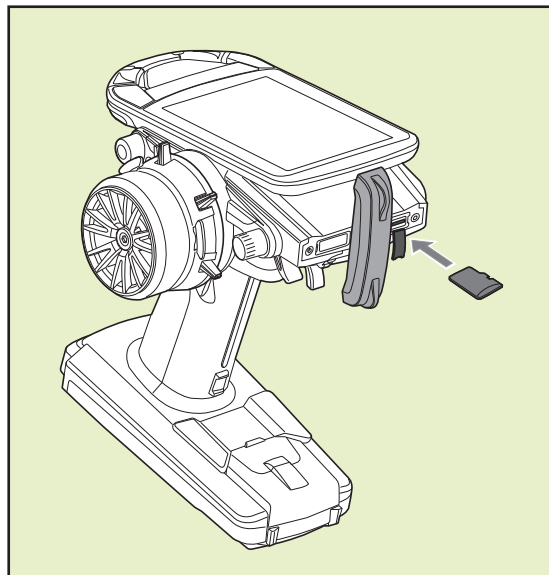

5. Turn on the transmitter power while pressing down the "HOME" button. The update screen appears on the LCD display of your T10PX and the software update is started.

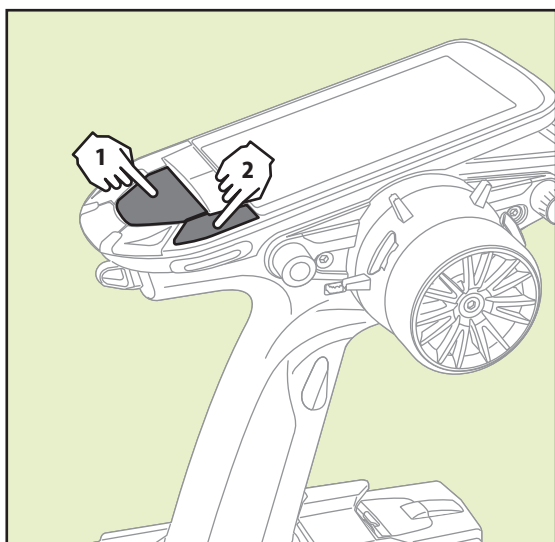

6. When the software update is completed, "Completed" message is shown on the LCD display of your T10PX. (Show below picture.)

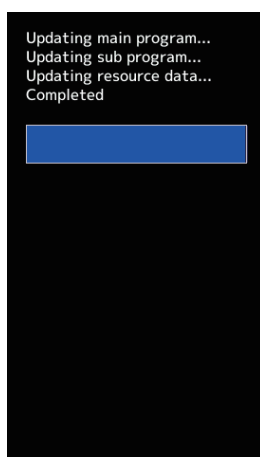

7. Turn off the power of T10PX.

Possible Problems

When one of the error messages shown below appears on the LCD screen your T10PX, the software update will not be completed.

"Low battery."

Software update is postponed because of low battery. Retry the software update after the battery is recharged.

"Update file not found."

The T10PX cannot find the update file on the microSD card. Check to be sure all the update files have been copied onto the microSD card.

"Broken file."

The T10PX detects the update file error. The update file may be broken or for another transmitter.

"Write error."

The software update procedure is stopped for an unknown reason. Contact your local service center when this error message appears on the LCD screen of your T10PX.

T10PX Version check

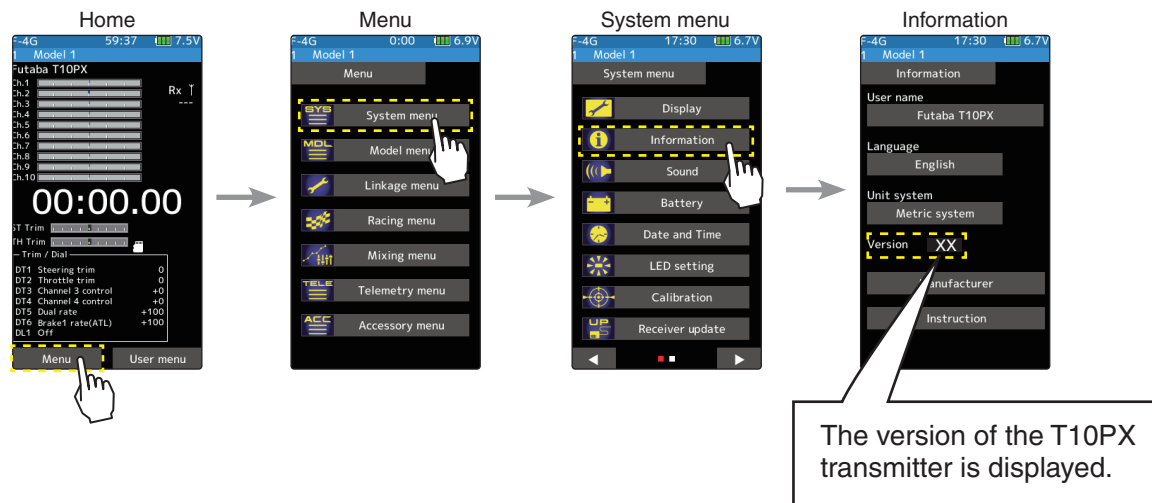

R404SBS(E) Version check

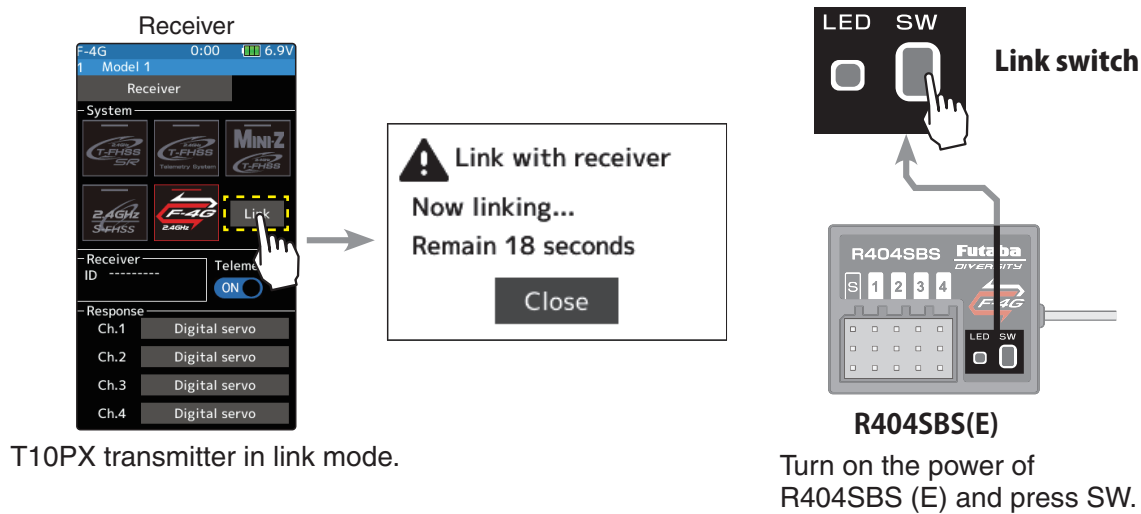

Receiver
ID xxxxxxxxxx
Version xx

The version of the R404SBS (E) receiver is displayed

When using the UR servo, make sure that it is Ver2.0.
Ver1.0 cannot be set wirelessly for UR servo, so upgrade to Ver2.0.

T10PX Software Update

Ver.4.0

1. Compatible with HPS-CB701

HPS-CB701 has been added to the UR mode / SR compatible servos.

2. Change ESC display name (TELEMETRY MENU)

Changed the name of the MC970CR/MC971CR/AcuVance ESC displayed in the telemetry function to "MC/AcuVance".

T10PX Software Update

Ver.3.1

1. Software fix sensor register (TELEMETRY MENU)

Fixed the problem that hobbywing telemetry adapter sensor registration may fail.

T10PX Software Update

Ver.3.0

1. HOBBYWING ESC telemetry compatible

◆ HOBBYWING ESC Register with T10PX

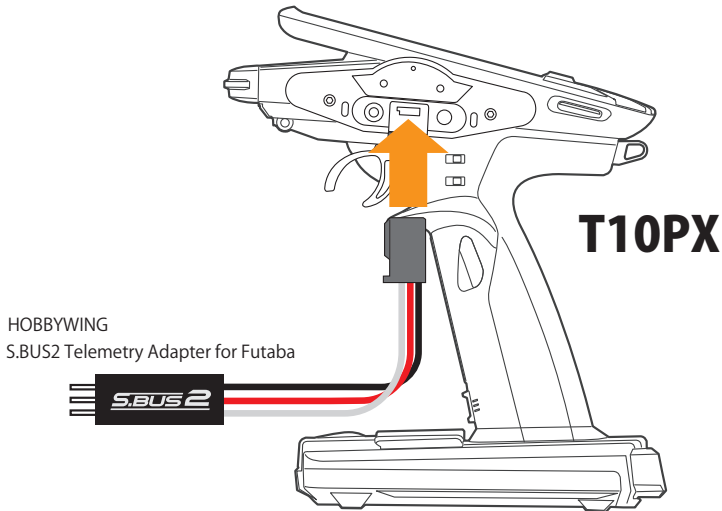

Connect the Hobbywing S.BUS2 Telemetry Adapter for Futaba to the COM port on the back of the T10PX.

Check the HOBBYWING website for compatible ESCs

Telemetry items vary by ESC. (Some ESCs do not display the telemetry items described in this manual.) Please contact Hobbywing for details.

*Please note that the proper default slot for this accessory is number 8. This sensor uses eight slots. Being made to a start slot are 8, 16, and 24. Information on how to change the slot assignment is included in the transmitter's manual.

T10PX screen

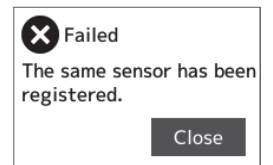
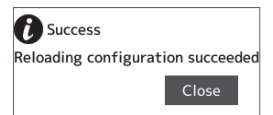
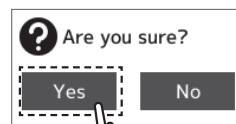
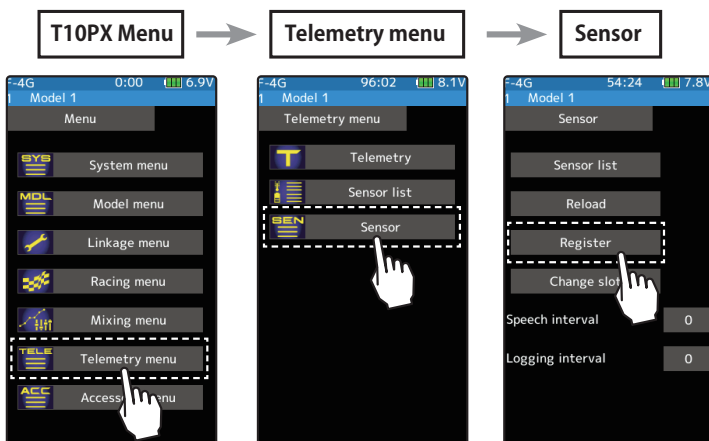

Confirm ESC connection

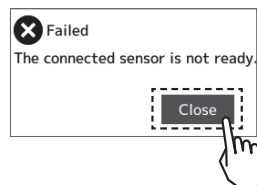

◆ The registered ESC will be displayed as "Hobbywing ESC".

This screen displays and sets the various information from the receiver. The telemetry can be used in the F-4G and THFSS system, but not in the THFSS-SR mode. An alarm and vibration can be generated depending on the information. Each information screen sets the alarm and the vibration. For example, a drop in the voltage of the receiver battery housed in the model car can be reported by an alarm. The telemetry data received last is memorized. Therefore, even if the receiver power is turned off, information display, audio guide, and alarms remain until the transmitter power is turned off. The speech function can be turned on and off with the specified switch.

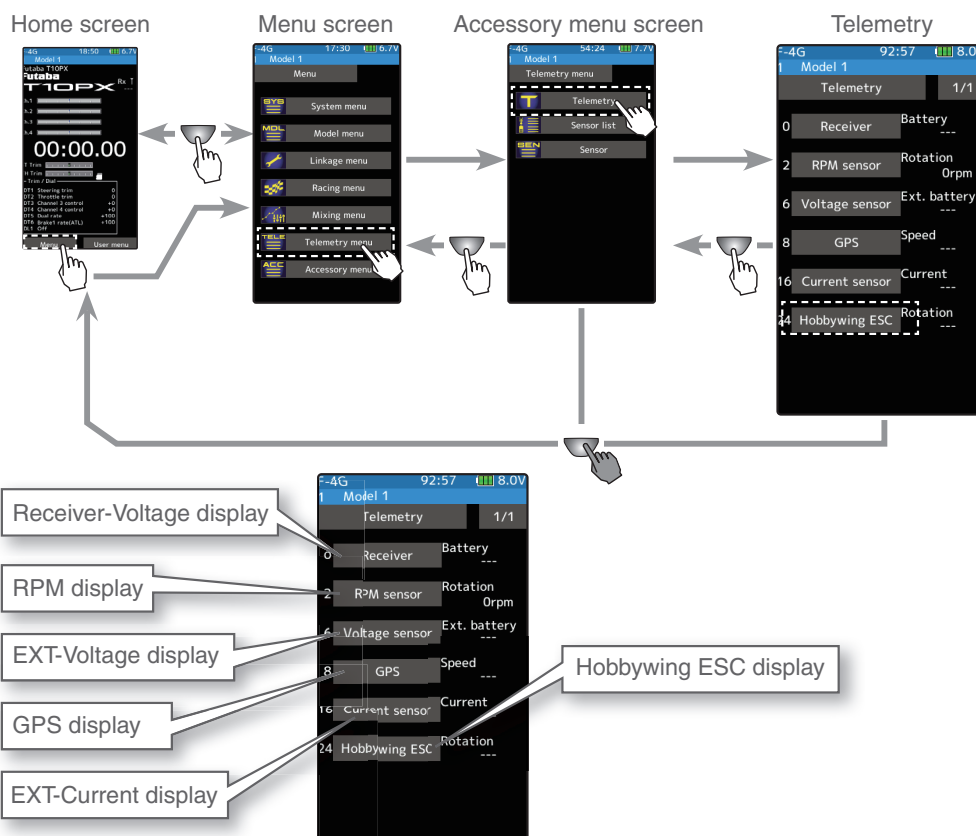

Using Telemetry function

(Preparation)

Hobbywing ESC + S.BUS2 Telemetry Adapter for Futaba used is connected with the receiver.

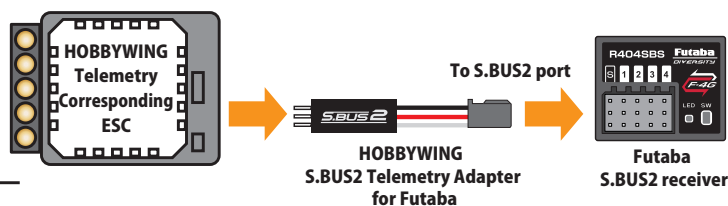

1 (Function ON/OFF)

Tap telemetry (ON) or (OFF) to select ON/OFF.

"OFF": Telemetry function OFF

"ON": Telemetry function ON

2 When finished, return to the Linkage menu screen by pressing the HOME button.



Telemetry function ON

Telemetry : Current • Voltage • Capacity • Rotation

The current, voltage, and capacity consumption of the power battery connected to the ESC can be monitored by the transmitter. In addition, the rotation speed of the motor can be monitored. If it becomes higher (lower) than the set value, you can be notified by an alarm or vibration.

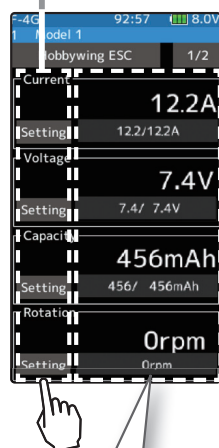
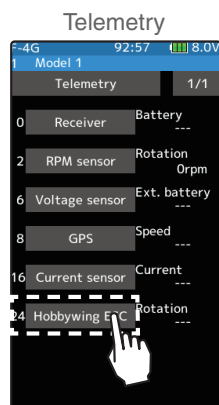

-Upper side:

Current current/voltage/consumption capacity/rotation display.

-Lower:

This is a display of the minimum value/maximum value of the measured current/voltage/consumption capacity/rotation after turning on the transmitter power.

* Tap the min/max display button to restart the measurement.

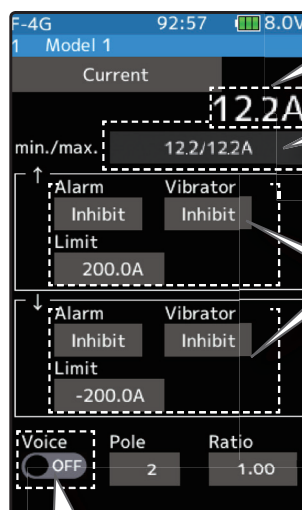

Current drive battery electric current

The minimum and maximum when powering ON are shown.

Alarm and vibrator ON/OFF and type setting (The ↓ arrow indicates that an alarm is generated when the electric current drops below the set value and the ↑ arrow indicates that an alarm is generated when the electric current exceeds the set value.)

The Speech function (ON/OFF)

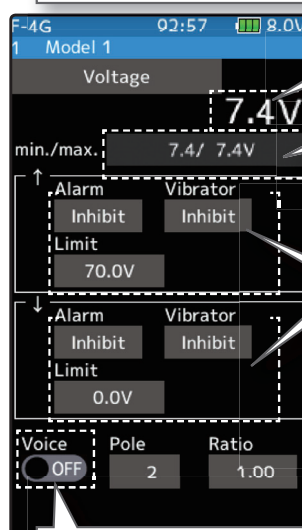

Current drive battery voltage

The minimum and maximum when powering ON are shown.

Alarm and vibrator ON/OFF and type setting (The ↓ arrow indicates that an alarm is generated when the battery voltage drops below the set value and the ↑ arrow indicates that an alarm is generated when the battery voltage exceeds the set value.)

The Speech function (ON/OFF)

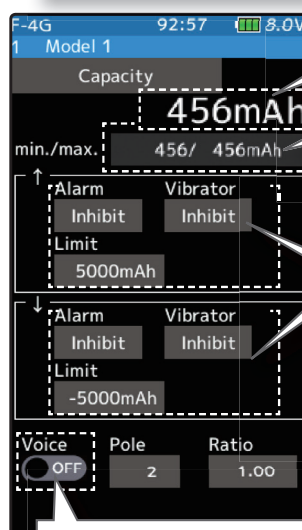

Current drive battery capacity

The minimum and maximum when powering ON are shown.

Alarm and vibrator ON/OFF and type setting (The ↓ arrow indicates that an alarm is generated when the battery capacity drops below the set value and the ↑ arrow indicates that an alarm is generated when the battery capacity exceeds the set value.)

The Speech function (ON/OFF)

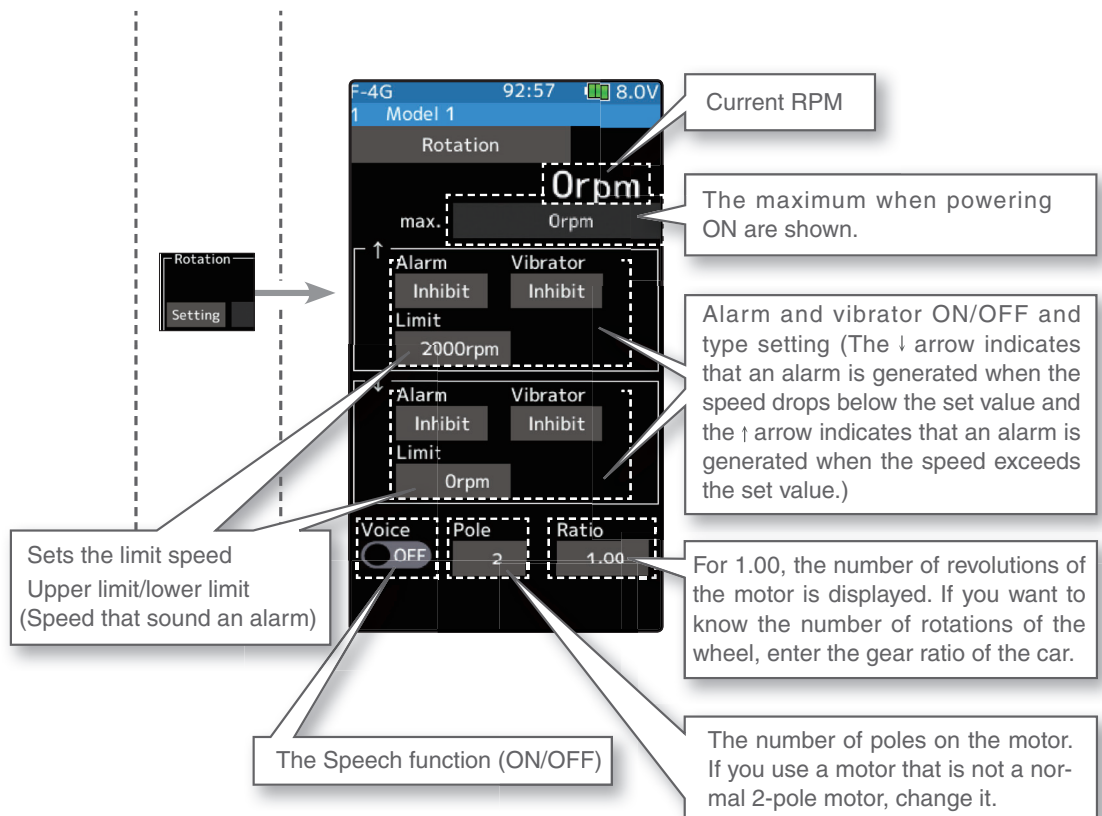

Telemetry items vary by ESC. (Some ESCs do not display the telemetry items described in this manual.) Please contact Hobbywing for details.

Telemetry : ESC Temp • Motor Temp • Throttle position

The ESC Temp, Motor Temp, and throttle position can be monitored by the transmitter. If it becomes higher (lower) than the set value, you can be notified by an alarm or vibration.

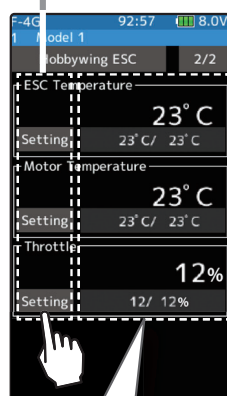
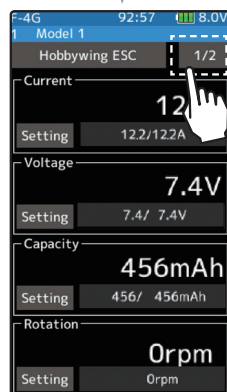
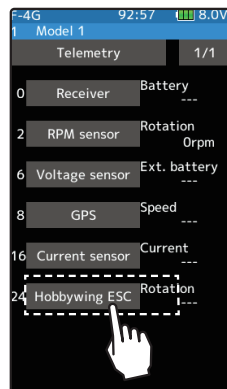

-Upper side:

Current ESC Temp/Motor Temp/Throttle position display.

-Lower:

This is a display of the minimum value/maximum value of the measured ESC Temp/Motor Temp/Throttle position after turning on the transmitter power.

* Tap the min/max display button to restart the measurement.

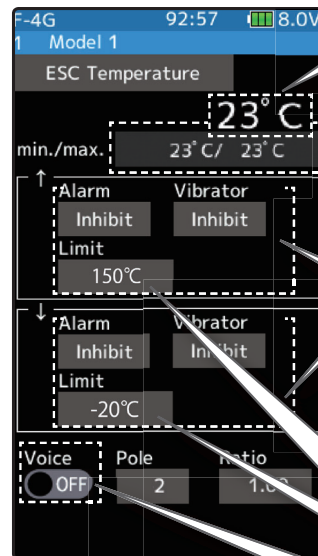

Current temperature

The minimum and maximum the when powering ON are shown.

Alarm and vibrator ON/OFF and type setting (The ↓ arrow indicates that an alarm is generated when the TEMP drops below the set value and the ↑ arrow indicates that an alarm is generated when the TEMP exceeds the set value.)

Limit temperature setting (Temperature that sounds an alarm)

The Speech function (ON/OFF)

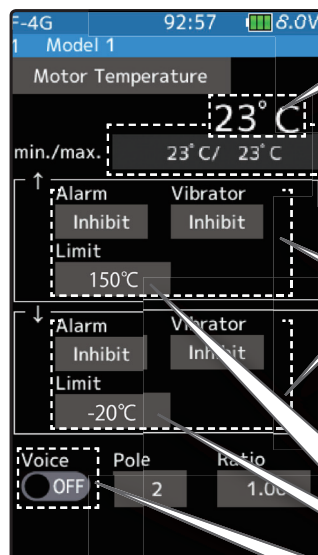

Current temperature

The minimum and maximum the when powering ON are shown.

Alarm and vibrator ON/OFF and type setting (The ↓ arrow indicates that an alarm is generated when the TEMP drops below the set value and the ↑ arrow indicates that an alarm is generated when the TEMP exceeds the set value.)

Limit temperature setting (Temperature that sounds an alarm)

The Speech function (ON/OFF)

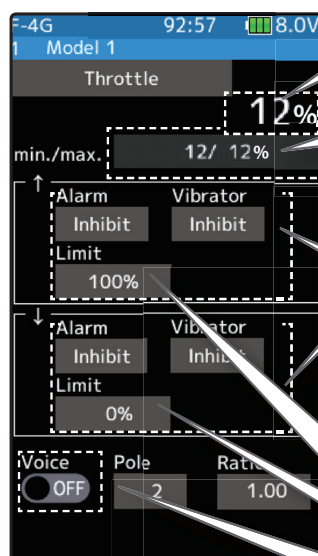

Current position

The minimum and maximum the when powering ON are shown.

Alarm and vibrator ON/OFF and type setting (The ↓ arrow indicates that an alarm is generated when the throttle position lower below the set value and the ↑ arrow indicates that an alarm is generated when the throttle position higher the set value.)

Limit throttle position setting (Throttle position that sounds an alarm)

The Speech function (ON/OFF)

Alarm and Vibrator function setup

1

(Limit adjustment)

Tap the [Limit]. Value input buttons appear on the screen.

Use the [+] or [-] button to adjust the limit value.

Adjustment buttons

- Adjust with the [+] and [-] buttons.
- Return to the initial value by tapping the [reset] buttons.

2

(Alarm function setup)

Tap the [Alarm] type and select [Inhibit], [Buzzer] or [Voice].

"Inhibit": No audible alarm

"Buzzer": Audible alarm

"Voice": Voice alarm

Setting

- Tap alarm type.
Inhibit/Buzzer/Voice

3

(Vibrator function setup)

Tap the [Vibrator] type and select [Inhibit], [Type 1], [Type 2], or [Type 3].

"Inhibit": No active vibration

"Type 1": Continuous vibration

"Type 2": Intermittent vibration for a long time

"Type 3": Intermittent vibration for a short time

Setting

- Tap Vibrator type.
Inhibit/Type 1/Type 2/Type 3

4

(Speech function setup)

Tap the "Voice" (ON) or (OFF) to select ON/OFF.

"OFF": No voice guide

"ON": Information loaded by voice

Setting

- Tap (ON)/(OFF).

*The voice guide loading interval is set by sensor menu.

5

When finished, return to the Telemetry screen by pressing the HOME button.

T10PX Software Update

Ver.2.1

1. Software fix S.BUS servo screen (ACCESSORY MENU)

Fixed a problem that occurs when using SR servo on the S.BUS servo screen.

T10PX Software Update

Ver.2.0

1. About Ultra Response UR Mode

ULTRA RESPONSE

The T10PX F-4G system provides the fastest Futaba response (as of 2022/5) when used in combination with the Futaba New UR Servo. Follow the steps below to switch the settings. UR mode can only be used with F-4G systems. It can be used with T10PX / R404SBS (E) Ver.2 or later. Futaba WEB site <https://futabausa.com/> Alternatively, download the data from the WEB site of the local distributor and update the T10PX / R404SBS (E) to use it.

Procedure for changing T10PX settings

It is necessary to relink and restart the receiver power supply after changing the settings.

- 1 Set the transmitter "PWR" side power switch to ON. From the Home screen, press the HOME button or tapped [Menu] on the touch panel. Next, select [Receiver] at the Linkage menu and access the set-up screen shown below by tapping the screen.

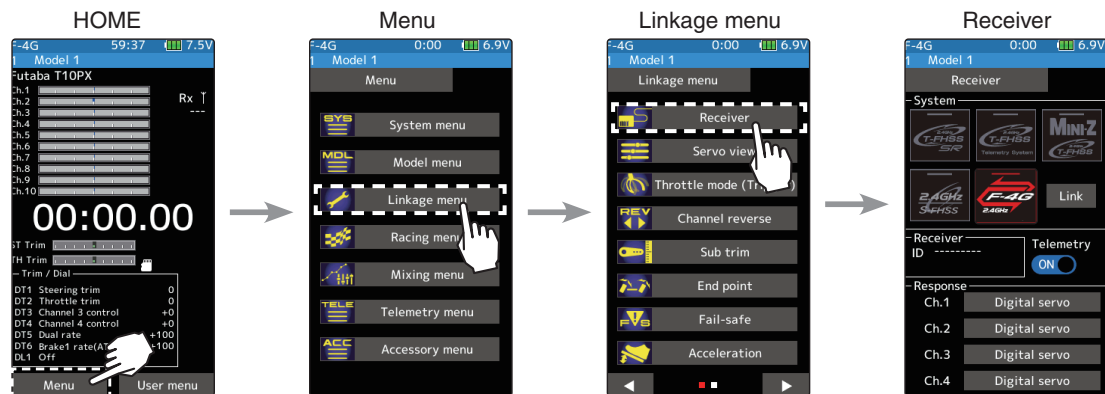

UR mode can only be used with the F-4G.

- 2 In the case of F-4G, 4 types of response settings can be set for each channel according to the servo used. Select UR mode when using the UR servo set to UR mode.

- UR mode : UR servo (Set to UR mode)
- Digital servo
- SR mode : UR/SR servo (Set to SR mode)
- Analog servo

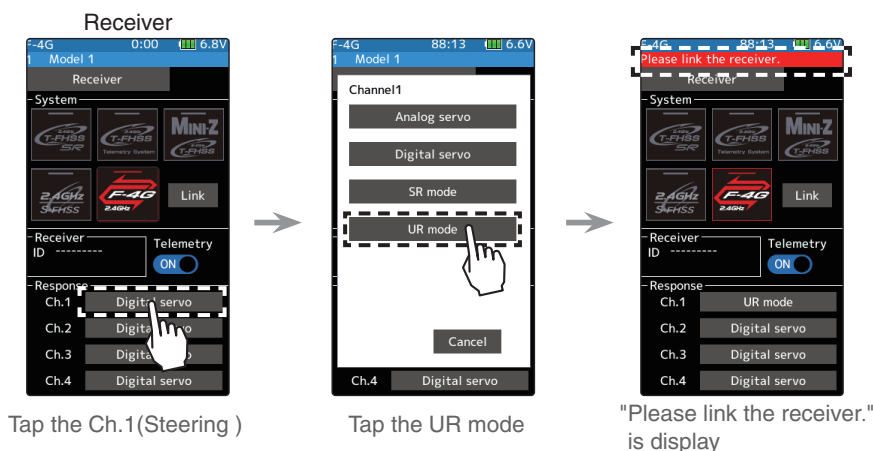

Tap the Ch.1(Steering)

Tap the UR mode

"Please link the receiver." is display

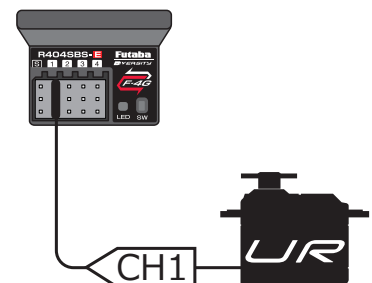

Use UR servo for steering

Note: In UR mode ON, normal servo, ESC, and standard gyro will not operate.

- 3 When using battery fail-safe, set the Battery Fail-safe Voltage in the "Fail-safe" in the "Linkage menu".

*In the F-4G system, the Battery Fail-safe voltage is set at the time of linking. Relink when changing Battery Fail-safe voltage.





- 4 Bring the transmitter and receiver within 50 cm of each other (antennas do not touch) and turn on the receiver power.
- 5 Touch [Link] on the transmitter T10PX screen, you will hear a chime sound and T10PX will enter the link mode for 20 seconds.
- 6 During the 20 seconds link mode, press the receiver for at least 2 seconds. The LED blinks red and then changes to a greenish red → green steady light. When the T10PX makes a beeping sound and the message "Link with receiver" appears on the screen, release the receiver push switch. This ends reading of mutual ID and displays the memorized receiver ID number on the T10PX screen. Power cycle the receiver. If the "Receiver not found" error screen is displayed, linking failed. Check the set contents and repeat the linking operation.
- 7 Once the settings are complete, turn the receiver off and then on again. The response and battery fail-safe voltage settings will take effect after the receiver is restarted.

Receiver Mode Precautions

⚠ Caution

❗ Be sure to use the T10PX receiver setting and the servo to be used under predetermined conditions.

Under other conditions, the set will not operate, or the specified performance will not be displayed even if it operates. In addition, it may cause servo trouble. Futaba will not be responsible for problems caused by the use of other than genuine Futaba parts. Use the parts specified in the instruction manual and catalog.

System	Receiver	Response	Usable servo
	R404SBS R404SBS-E	UR mode	• Futaba UR servo 
		SR mode	• Futaba SR servo
		Digital servo	• Futaba Digital servo
		Analog servo	• Futaba Digital servo/Analog servo
	R334SBS R334SBS-E	SR mode channel ON	• Futaba SR servo
		SR mode channel OFF	• Futaba Digital servo
	R324SBS R314SB R314SB-E R304SB R304SB-E R202GF R203GF R204GF-E R214GF-E R2104GF	Digital servo	• Futaba Digital servo
		Analog servo	• Futaba Digital servo/Analog servo

- For servos for which the operation mode can be set, change the servo operation mode according to the system to be used. If the operating modes of the system and servo are different, it will fail.
- Use UR servo (Set to UR mode) for UR mode. Use SR/UR servo (Set to SR mode) for SR mode.
- When the UR(SR) mode is ON, it is exclusively for our UR(SR) compatible servo. Using a servo other than the UR(SR) compatible servo may cause the servo or receiver to malfunction.
- If a normal servo is connected to a CH with UR/SR mode ON, there is a risk of damage.
- Do not connect UR/SR servo (set to UR/SR mode) and analog servo in digital servo mode.
- Do not connect UR/SR servo (set to UR/SR mode) in analog servo mode.
- UR/SR servo can be used digital or analog when set to normal mode.
- Connecting an UR/SR mode compatible servo set to UR/SR mode to the S (S.BUS2 port) may cause malfunction of the servo or receiver.
- Receiver battery: Matched to the ratings of the receiver and connected servo (dry cell battery cannot be used).
- Fail-safe Unit cannot be used because the system is different. Use the fail-safe function of the transmitter.

UR servo setting change procedure

The initial setting of the **UR servo** is **normal mode**.

To use it in UR mode, you need to switch to UR mode by following the steps below.



The initial setting is Normal mode

The following modes can be selected for the UR servo.

Normal

SR type 1

SR type 2

SR type 3

UR type 1

UR type 2

UR type 3

UR type 4

1 Connect the UR servo as shown.

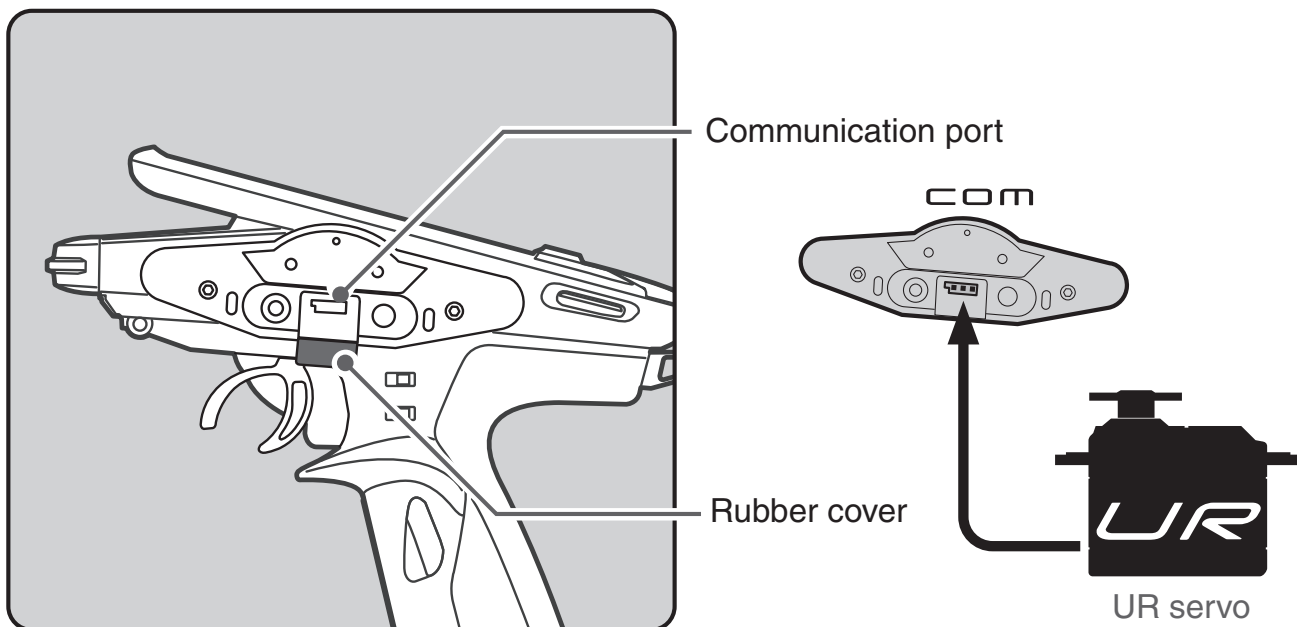

- When changing the UR / SR mode settings, be sure to use the wired method. Cannot change the servo between normal mode and UR / SR mode in the wireless setting. Once set to UR mode, switching between UR1 / UR2 / UR3 / UR4 can be done wirelessly.

2 Turn on T10PX and call Menu → Accessories Menu → S.Bus servo screen.

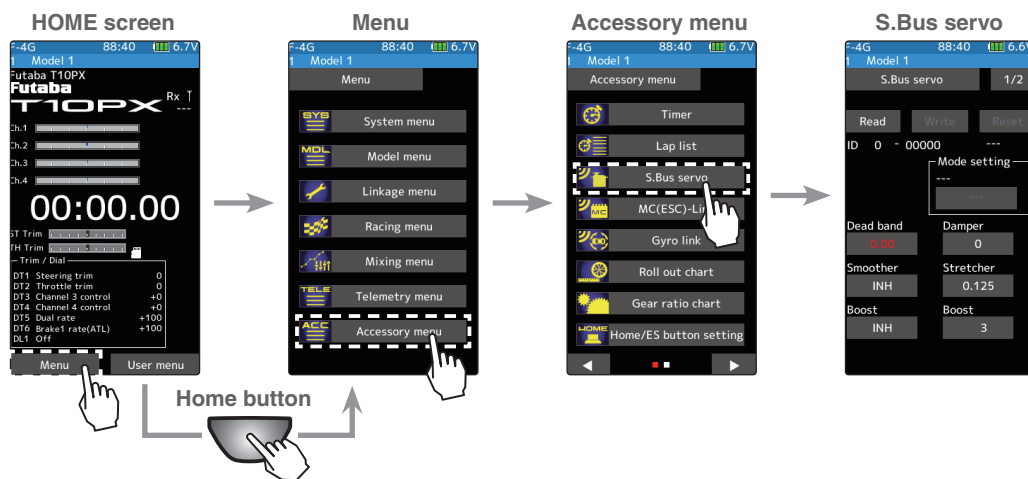

3 Read the connected UR servo data into the T10PX.

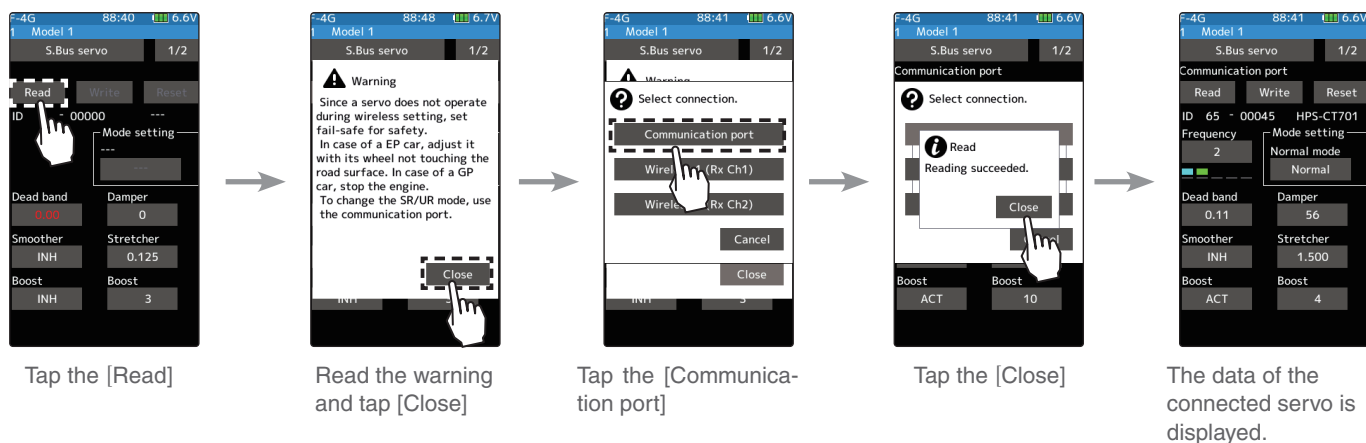

4 Change to UR mode, select UR type, and write data to the connected UR servo.

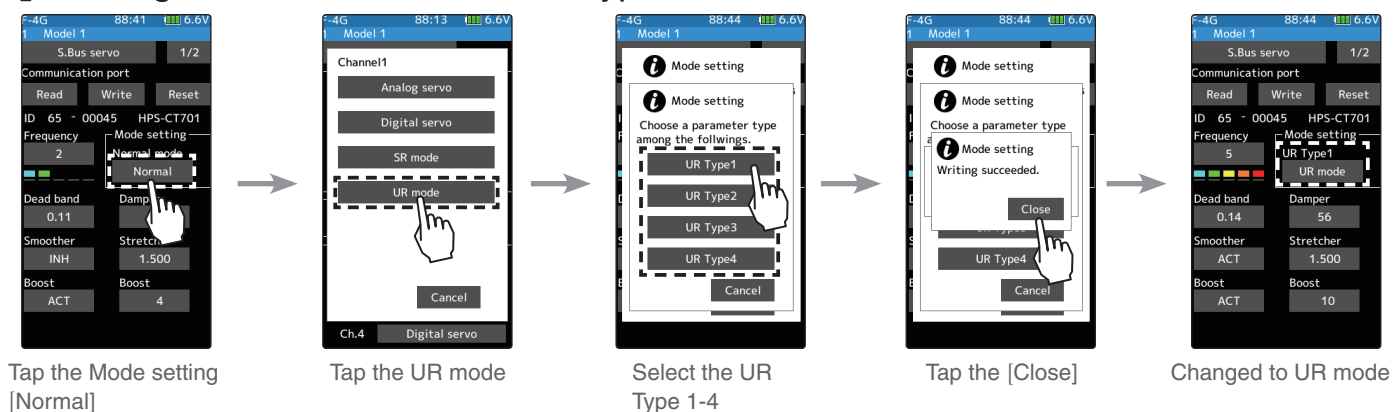

5 Remove the UR servo from the transmitter. It can be used as a servo in UR mode.



UR mode

UR TIP
 •Servo parameter setting "Frequency"
 Hunting occurs when the servo frequency is set high, but this is not a malfunction. Use by lowering the frequency value.

2. Compatible with HPS-CT701

HPS-CT701 has been added to the UR mode / SR compatible servos.

3. Compatible with MC971CR

It corresponds to MC971CR. MC971CR is added to the selection screen of the MC (ESC)-Link function.

***[Important]** "Torque level" and "Torque end point" function can operate only when using ACUVANCE brushless motor "LUXON AGILE" and "FLEDGE".
When using a motor of ACUVANCE "LUXON BS" and "LUXON", or a motor of other than ACUVANCE, setting isn't possible or it doesn't operate properly.

4. A function to change the data on the setting screen has been added to the trim / dial function of the linkage menu.

Instead of operating the [-] [+] buttons on the touch panel, you can change the value by trimming / dialing.

- 1 Open the Trim / Dial Settings screen and select the trim / dial to assign to the operation to change the setting data.

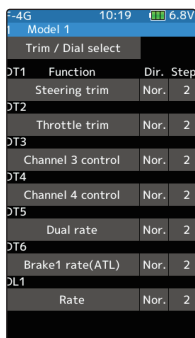

- 2 From the list, select Rate.

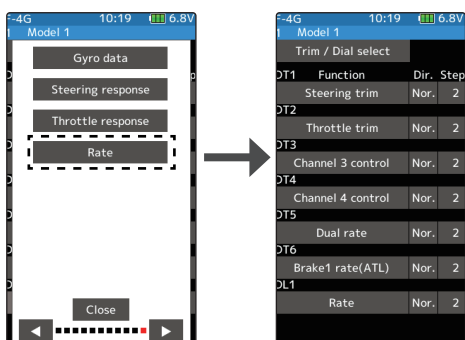

- 3 Open the screen of the function to make adjustments, and touch and select the item for which you want to change the setting data. The data will be changed by operating the trim / dial assigned earlier.

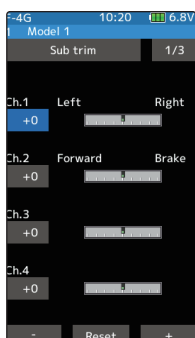

*If the item whose data you want to change is not selected and the [-] [+] buttons are not displayed on the screen, the data will not be changed even if you operate the trim / dial.

5. The brake display can now be selected for the instrument panel displayed on the home screen.

1 Touch [Normal] on the Upper side in the Home screen settings of the Accessories menu.

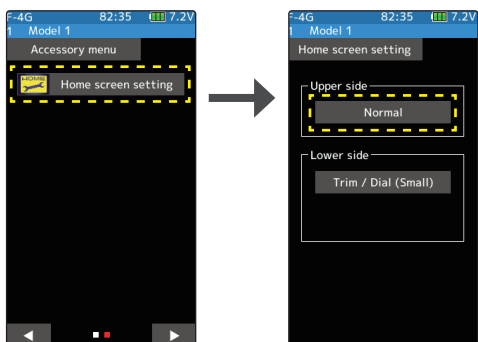

2 Touch the Instrument panel to be set on the home screen to select it.

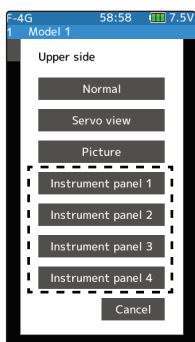

3 Select [Brake].

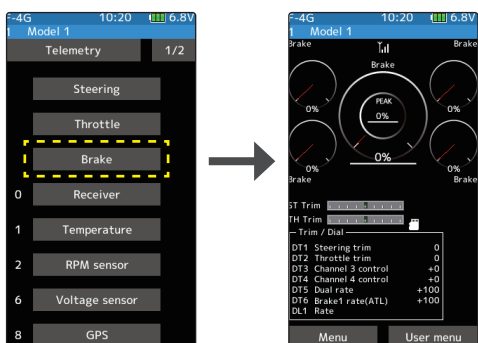

6. Fixed an issue where the current time might be initialized at startup in rare cases.